

PUMP & WELL RECORD

OWNER: <u>Watersield, JoAnn</u>		DATE: <u>9-3-99</u>
ADDRESS: <u>502 Clayborn Ave</u> <u>Takoma Park Md 20112</u>		LOCATION OF WELL: <u>Misty Meadows</u>
<u>202-720-5115</u>		
WELL DEPTH: <u>280</u>	PUMP MODEL: <u>85B07422</u>	TANK SIZE & TYPE: <u>WM-6 UG</u>
FLOW RATE: <u>30 GPM</u>	PUMP SERIAL NO: <u>63896</u>	CABLE SIZE: <u>12/2</u>
PUMPING WATER LEVEL: <u>20</u> <u>2.55</u>	HORSEPOWER: <u>3/4 2HP</u>	CABLE LENGTH: <u>440'</u>
PUMP SETTING: <u>255</u>	MOTOR MAKE: <u>F</u>	HEATERS USED:
PIPE SIZE: <u>1" 160</u>	MOTOR DATE CODE: <u>99F18 15-0077</u>	CURRENT & VOLTAGE READING (BY LEG) } L-1 _____ L-2 _____ L-3 _____
CASING SIZE: <u>6 7/8</u>	3 PHASE STARTER SIZE	

SS 177 7/99

INSPECTION TO BE PRINTED OR TYPED

STATE OF WEST VIRGINIA

WINGFIELD HEALTH DEPARTMENT

Permit No.: ST 00-030

Tax Map: _____ Parcel #: _____

County: WINGFIELD

ON-SITE SEWAGE DISPOSAL SYSTEM INSPECTION FORM

County Road: _____

Name of Owner: V. WATERSFIELD Installer: D. DAUGHERTY

Address: 107 CLAYBORN AVE TAKOMA PARK MD

Property Location: Misty Meadows Lot # 22

Type of Facility: House Facility is: New (Y) Existing () Lot Size: 7 Sq. Ft./Acres

Design Loading in gpd/No. Bedrooms: 3BR Source of Water Supply: well

SEWAGE TANK COMPONENT

Capacity in Gallons: 1000 Material: concrete Manufacturer: VITTO

Distances (in feet) of Tank to: Dwelling: 10' Private (X)/Public () Water Source: 50' Property Line: 100'

ON-SITE DISPOSAL SYSTEM

Class I Systems: Standard Soil Absorption Trenches () or Bed () Gravelless Pipe (4" Diameter: 10 inches)
 Chamber Soil Absorption Trenches () or Bed ()
 Class II Systems: Pumped/Deepest Soil Absorption Trenches () or Bed () Evapotranspiration Trenches () or Bed ()
 Shallow Soil Absorption Trenches () or Bed () Other: _____

No. of Lines: 3 Length (in feet) of Each: 100, 100, 100

Width of Trenches: 24 inches/feet Depth to Bottom of Field: 24 inches

If Bed, Dimensions (in Feet): _____ If Chamber System, Name: _____ No. of Units: _____

Approved and Adequate Materials Used? Yes (X) No () Size Equates to: 900 Square Feet of Standard Gravel Field.

Distances (in feet) of System to: Dwelling: 10' Private ()/Public () Water Source: 100' Property Line: 15'

An inspection indicates that the sewage disposal system described above **DOES MEET (X), DOES NOT MEET (), CANNOT BE DETERMINED TO MEET ()** the minimum standards established by the West Virginia Bureau of Public Health.

To correct a health hazard, modifications to existing systems may be done to improve part of a system. Such modifications may not be able to be designated as a does meet system since inadequate information is known.

Although many factors contribute to the successful functioning of a sewage disposal system, this office recommends water conservation and maintaining an even usage of water throughout the week.

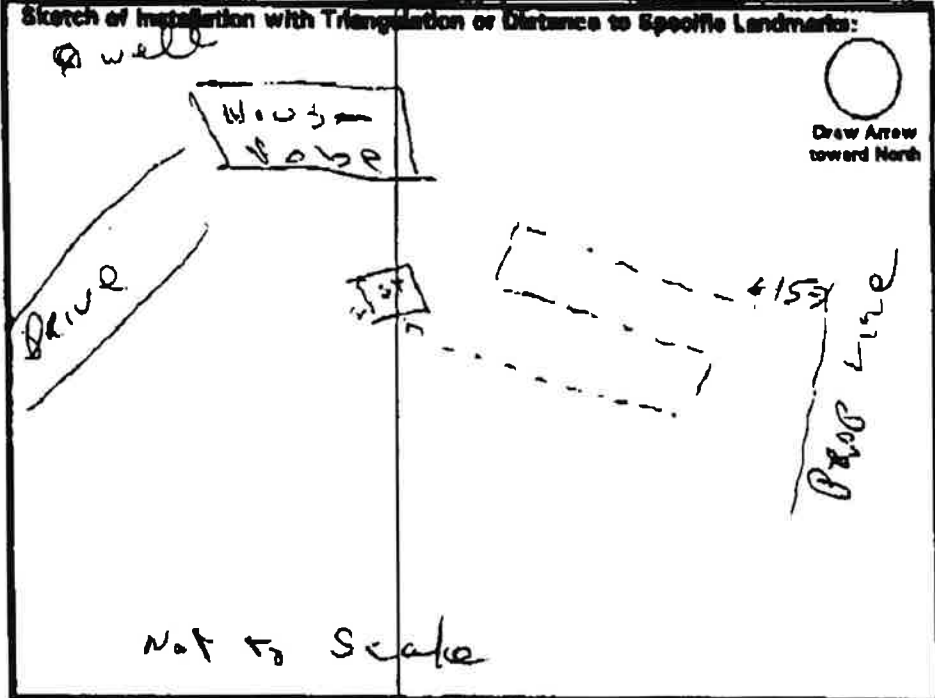

Visit Date(s): 2-26-99

Final Inspection Date: 8-6-99

Sanitarian: J. L. [Signature]